



BETTA Clean 10 DELUXE AQUARIUM FILTER



INSTRUCTIONS

ITEM# BF-10

Congratulations on your purchase of Zoo Med's BF-10 Betta Clean Filter! The following instructions will assist you with the proper set-up and operation of this filter. Please read the following instructions carefully. If you have any questions regarding these instructions or the proper use of this item, please contact our customer service department at zoomed@zoomed.com or by calling (888) 496-6633 (US and Canada only). Customers in other countries, please call (805) 542-9988.

FEATURES:

- Filters up to 40 gallons per hour
- Provides sufficient filtration for Betta tanks with up to 10 gallons of water
- Highly efficient filter that only uses 3.5 watts!
- Can be mounted vertically in a corner or horizontally for shallow tanks

ASSEMBLY INSTRUCTIONS

Remove contents from box and inspect to make sure there are no missing parts. Refer to the parts diagram to identify parts mentioned in the following assembly instructions. Replacement parts are available online by visiting the 'Online Store' section of our website at www.zoomed.com or by contacting customer service.

Connect the spray bar to the outflow arm. If you intend to have your filter positioned horizontally in your tank, you may put the elbow attachment on the spray bar before connecting it to the outflow arm (see figure 1).

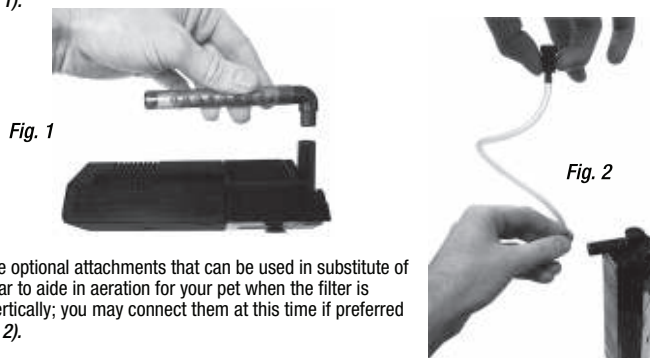

Fig. 1

Fig. 2

Included are optional attachments that can be used in substitute of the spray bar to aide in aeration for your pet when the filter is mounted vertically; you may connect them at this time if preferred (see figure 2).

INSTALLATION

Position the filter in an ideal location in your tank for adequate water circulation. Make sure to clean the glass surface thoroughly from algae or water deposits. Firmly press the filter in place, ensuring that the filter is fully submersed.

FLOW ADJUSTMENT

The flow can be adjusted by rotating the round knob on the outlet tube to achieve your desired flow rate. During initial setup, adjust the outflow valve (see figure 3) to its highest setting to purge air from the filter. When there is no longer air coming out of the spray bar, you may adjust the valve towards the min or max indicator as necessary. *Note: Many Bettas prefer slow moving water. Keep the flow set to low for poor swimmers or fish with extra finnage (i.e. Dumbo Ear, Double Tail, etc...)

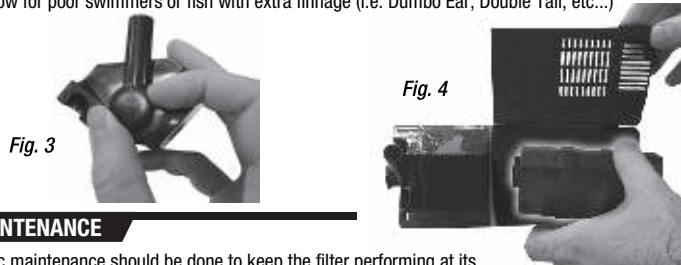

Fig. 3

Fig. 4

MAINTENANCE

Periodic maintenance should be done to keep the filter performing at its best. If the flow rate decreases or the water clarity declines, unplug the filter and open the trap door to replace the fouled cartridge with a clean unit (See figure 4). Once the new cartridge is in place, close the trap door and plug your filter back in. This should be done at least every 3 weeks, or sooner, to maintain proper water clarity.

VERY IMPORTANT SAFETY INSTRUCTIONS:

WARNING! To guard against injury, basic safety precautions should be observed, including the following:

READ AND FOLLOW ALL SAFETY INSTRUCTIONS

- **DANGER** – To avoid possible electric shock, special care should be taken since water is employed in the use of aquarium equipment. For each of the following situations, do not attempt repairs by yourself; return the appliance to an authorized service facility for service or discard the appliance:
 - Carefully examine the appliance after installation. It should not be plugged in if there is water on parts not intended to be wet.
- **DO NOT** operate any appliance if it has a damaged cord or plug, or if it is malfunctioning or has been dropped or damaged in any manner.
- To avoid the possibility of the appliance plug or receptacle getting wet, position tank/aquarium stand and tank to one side of a wall-mounted receptacle to prevent water from dripping onto the receptacle or plug. A "drip loop," shown in figure 5, should be arranged by the user for each cord



- | | | |
|--------------------|--------------------------------|------------------------------|
| 1. Top cover | 5. Motorhead | 9. Spray bar |
| 2. Stator assembly | 6. Cartridge joint | 10. Elbow connector |
| 3. Impeller | 7. 3 piece filter cartridge | 11. Straight connector |
| 4. Impeller cover | 8. Intake cover with trap door | 12. Venturi inlet joint |
| | | 13. Venturi valve and tubing |

connecting an aquarium appliance to a receptacle. The "drip loop" is that part of the cord below the level of the receptacle, or the connector if an extension cord is used, to prevent water from traveling along the cord and coming in contact with the receptacle. If the plug or receptacle does get wet, **DON'T** unplug the cord. Disconnect the fuse or circuit breaker that supplies power to the appliance. Then, unplug and examine for presence of water in the receptacle.

- Close supervision is necessary when any appliance is used by or near children.
- Always unplug an appliance from an outlet when not in use, before putting on or taking off parts, and before cleaning. Never yank cord to pull plug from outlet. Grasp the plug and pull to disconnect.
- **DO NOT** use an appliance for other than intended use. The use of attachments not recommended or sold by the appliance manufacturer may cause an unsafe condition. Do not install or store the appliance where it will be exposed to the weather or to temperatures below freezing.
- For indoor use only, for aquarium/vivarium use only.
- Make sure an appliance mounted on a tank is securely installed before operating it.
- Read and observe all the important notices on the appliance.
- If an extension cord is necessary, a cord with a proper rating should be used. A cord rated for less amperes or watts than the appliance rating may overheat. Care should be taken to arrange the cord so that it will not be tripped over or pulled.

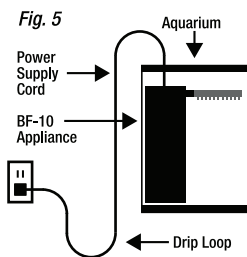

Fig. 5

SAVE THESE INSTRUCTIONS

WARRANTY

This product is guaranteed against manufacturing defects for 12 months from the date of purchase. In the unlikely event of a failure, the unit should be returned to **ZOO MED** within one year of purchase, together with the original sales receipt. It is important that the unit is not tampered with. Please note; this guarantee is not valid if the defects are caused by tampering, negligence, misuse, or by not observing the safety warnings. **ZOO MED** assumes no responsibility for indirect damage that may result from the use of this appliance.

ZOO MED
LABORATORIES, INC.

3650 Sacramento Dr. • San Luis Obispo, CA 93401 U.S.A.
Phone: 805-542-9988 • E-mail: zoomed@zoomed.com

ZOOMED.COM